

Type : T/RH Cores

Ordering Code:

Shape:

Type:1

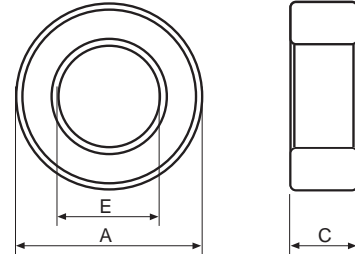

Type:2

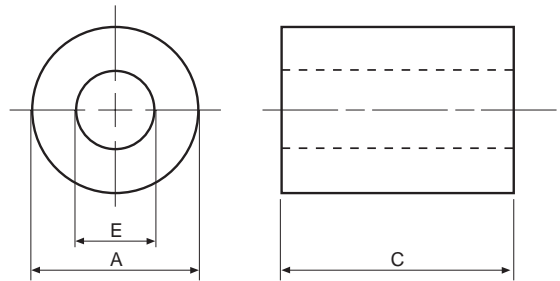

K08 **T2.03*1.27*0.76** **P** **G**
 Material Core Size Coating Gapped AL Value
 材質 品名 塗裝

C : Epoxy Coating
 P : Parylene Coating
 W : Powder Coating

DIMENSIONS AND EFFECTIVE PARAMETERS

| CORES | DIMENSIONS (mm) | | | EFFECTIVE PARAMETERS | | | | | |
|------------------------|---------------------------|-------------|-------------|------------------------------------|--------|----------------------|----------------------|-----------|------|
| | P COATING DIMENSIONS (mm) | | | C ₁ (mm ⁻¹) | Le(mm) | Ae(mm ²) | Ve(mm ³) | Wt(g/set) | Type |
| | A | E | C | | | | | | |
| T2.03x1.27x0.76 | 2.03 ± 0.15 | 1.27 ± 0.15 | 0.76 ± 0.15 | 17.95 | 5.18 | 0.29 | 1.00 | 0.0065 | 1 |
| | 2.03 ± 0.15 | 1.27 ± 0.15 | 0.76 ± 0.15 | | | | | | |
| T2.54x1.27x0.76 | 2.54 ± 0.15 | 1.27 ± 0.15 | 0.76 ± 0.15 | 12.40 | 5.99 | 0.48 | 3.00 | 0.13 | 1 |
| | 2.54 ± 0.15 | 1.27 ± 0.15 | 0.76 ± 0.15 | | | | | | |
| T2.54x1.27x1.27 | 2.54 ± 0.15 | 1.27 ± 0.15 | 1.27 ± 0.15 | 7.42 | 5.98 | 0.81 | 5.00 | 0.023 | 1 |
| | 2.54 ± 0.15 | 1.27 ± 0.15 | 1.27 ± 0.15 | | | | | | |
| T5.84x3.05x1.52 | 5.84 ± 0.15 | 3.05 ± 0.15 | 1.52 ± 0.15 | 6.58 | 1.96 | 2.12 | 30.00 | 0.146 | 1 |
| | 5.84 ± 0.15 | 3.05 ± 0.15 | 1.52 ± 0.15 | | | | | | |
| RH3x1.2x3.5* | 3.00 ± 0.15 | 3.50 ± 0.20 | 1.20 ± 0.15 | 2.10 | 6.60 | 3.15 | 20.79 | 0.10 | 2 |
| | 3.75max* | 4.30max* | 0.45min* | | | | | | |

ELECTRICAL CHARACTERISTICS

| CORES | AL ± 25% (nH/N ²) | | | | | | | |
|------------------------|-------------------------------|------|-----|-----|-----|-----|-----|-----|
| | K08 | K081 | K10 | K12 | B30 | B45 | B60 | B90 |
| T2.03x1.27x0.76 | 56 | | 70 | | | | | |
| T2.54x1.27x0.76 | 81 | | 101 | | | | | |
| T2.54x1.27x1.27 | 136 | | | | | | | |
| T5.84x3.05x1.52 | 76 | | 95 | | | | | |
| RH3x1.2x3.5 | | | | | | | | |

Remark:

1. AL Value Testing Condition : 100kHz, 100mV, 1Ts. If testing condition is different from ACME's, please specify upon request & ordering.
2. Coating Material
 - (1) Toroid Size T8 and Below:clear parylene coating, breakdown voltage:1000Vdc, coating thickness : 0.05mm max.
 - (2) Toroid Size T9 and Above:green epoxy coating, breakdown voltage:1500Vdc, coating thickness : 0.6mm max.
3. "*" : C (Epoxy) Coating Dimensions.